

Seal

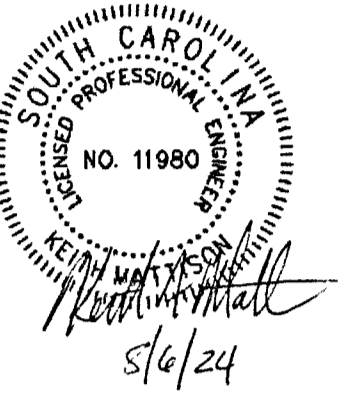
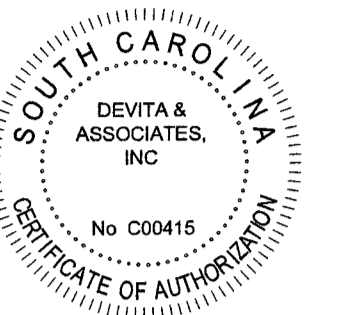

**DP3**  
ARCHITECTS

DP3 Architects, Ltd  
15 South Main Street, Suite 400  
Greenville, SC 29601  
864.232.8200  
www.DP3architects.com

Project

**MARIACHIS**  
RESTAURANT  
LANCASTER, SC

Project Number 23213  
Drawn By TLW  
Checked By KFM  
Date Issue Date

Revisions

Drawing

**FIRE PROTECTION**  
CRITERIA PLAN

**FP1.1**

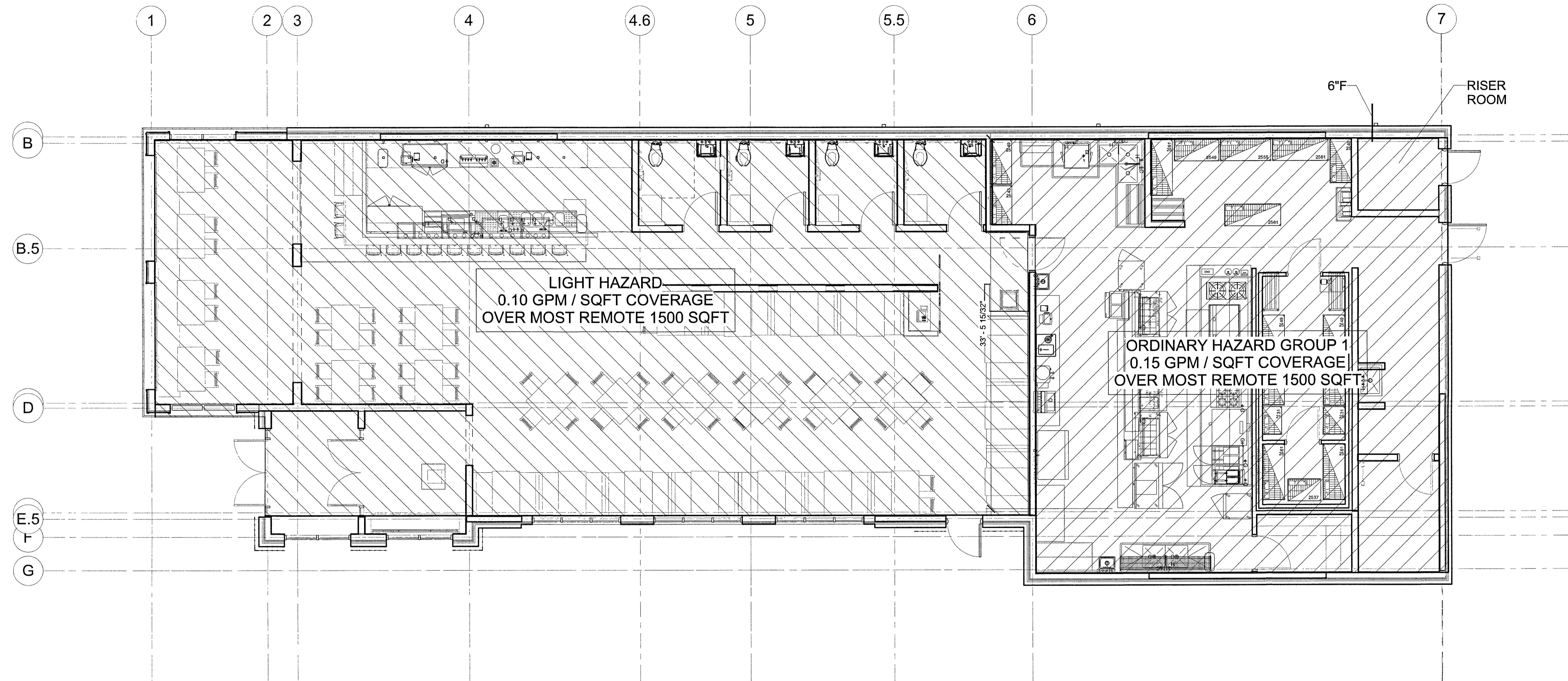

**1** FIRE PROTECTION CRITERIA PLAN  
FP1.1  
3/16" = 1'-0"  
0 8' 16' 24'

**GENERAL NOTES:**

- A. COORDINATE FIRE SPRINKLER HEAD LOCATIONS AND RELATED PIPING WITH THE REFLECTED CEILING PLAN AND ALL OTHER TRADES, EQUIPMENT, PIPING, ETC.
- B. FIRE SPRINKLER SYSTEM SHALL BE DESIGNED PER THE REQUIREMENTS OF CURRENT VERSION OF NFPA-13 AND LOCAL AUTHORITY HAVING JURISDICTION
- C. FIRE SPRINKLER CONTRACTOR SHALL SUBMIT SCALED (24"X36") LAYOUT DRAWINGS FOR THE FIRE PROTECTION SYSTEM, INDICATING HANGER LOCATIONS, PIPE SIZES, LOCATIONS, ELEVATIONS, SLOPE OF HORIZONTAL RUNS, WALL AND FLOOR PENETRATIONS AND CONNECTIONS. PROVIDE FIRE SPRINKLER HYDRAULIC CALCULATIONS. PROVIDE CUT SHEETS FOR ALL MATERIAL AND EQUIPMENT FOR REVIEW.
- D. PROVIDE FLOW SWITCH, SHUTOFF VALVE WITH TAMPER SWITCH AND BACKFLOW PREVENTERS AS REQUIRED BY LOCAL AND STATE CODES.
- E. THE BACKFLOW PREVENTER SHALL BE EQUIPPED WITH TAMPER SWITCHES AND SHALL BE TIED INTO THE FIRE ALARM SYSTEM. BACKFLOW PREVENTION DEVICE VALVES LOCATED ON FIRE LINE PIPING SHALL BE LOCKED IN THE OPEN POSITION. IN OCCUPANCIES REQUIRED TO BE EQUIPPED WITH A FIRE ALARM SYSTEM, THE BACKFLOW PREVENTER VALVES SHALL BE ELECTRICALLY SUPERVISED BY A TAMPER SWITCH INSTALLED IN ACCORDANCE WITH NFPA 72 AND SEPARATELY ANNUNCIATED.
- F. EXACT LOCATION AND NUMBER OF SPRINKLER HEADS SHALL BE FIELD VERIFIED AND ADJUSTED AT TIME OF INSTALLATION TO PROVIDE FULL COVERAGE.
- G. GENERALLY, IT IS THE INTENTION FOR FIRE SPRINKLER MAINS AND BRANCH LINES TO BE ROUTED BETWEEN RECESSED LIGHT FIXTURES AND TIGHT TO DECK ABOVE THE DUCTWORK.

**FIRE PROTECTION DESIGN CRITERIA**

DINING AREA, RESTROOMS						
CLASSIFICATION	DENSITY	AREA OF COVERAGE	COVERAGE PER SPRINKLER	DISCHARGE TEMPERATURE	MAXIMUM SPACING	HOSE STREAM ALLOWANCE
LIGHT HAZARD	0.10 GPM/SQ. FT.	1500 SQ. FT.	225 SQ. FT.	165°F	15 FT	100 GPM
KITCHEN / FREEZER / COOLER AREA						
CLASSIFICATION	DENSITY	AREA OF COVERAGE	COVERAGE PER SPRINKLER	DISCHARGE TEMPERATURE	MAXIMUM SPACING	HOSE STREAM ALLOWANCE
ORDINARY HAZARD GROUP 1	0.15 GPM/SQ. FT.	1500 SQ. FT.	130 SQ. FT.	165°F	15 FT	250 GPM